



School of
Public Policy

Master of Public Administration (MPA)

Information Session

14 March 2024





School of
Public Policy

Why LSE?



A global reputation...

Steeped in history -
Established in 1895

37 world leaders have studied
or taught at LSE
**18 Nobel prize
winners** among academics
and former students

219,000 alumni
across **212 countries**

A hub of global debate –
100's of expert guest speaker
events and festivals

Ranked top university in
London for 11 years running
(Complete University Guide
2023)

**1st Carbon Neutral verified
university** in the UK





A central location...



A vibrant campus...

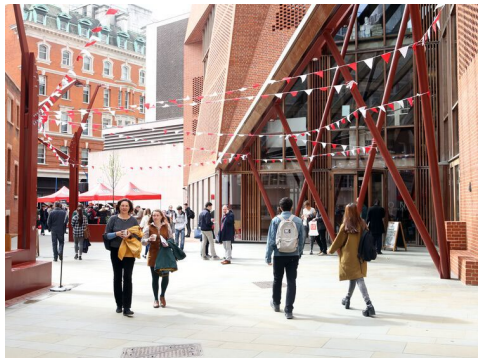
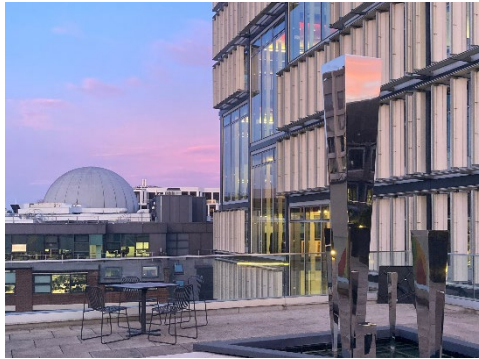

MPA Programme

- 2 years, full-time
- For early-stage career.
No requirement for prior professional experience.
- Combines methodological discipline and practical application through Capstone Project with external client.





MPA Students

2023/4 - Year 1

- 66 class size
- 27 average age
- 4 years (avg.) professional work experience
- 24 nationalities represented

MPA Year 1

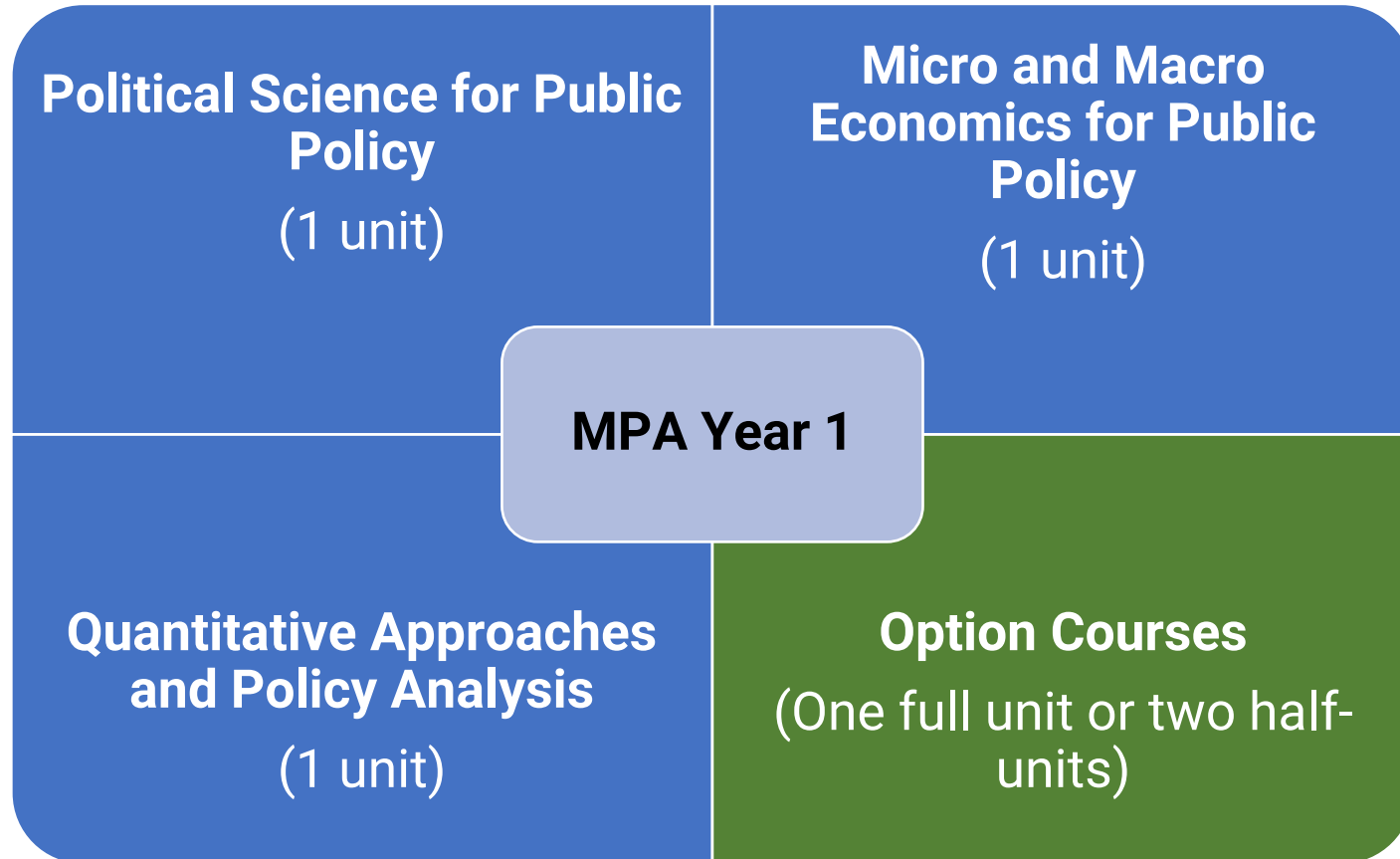

MPA Year 2

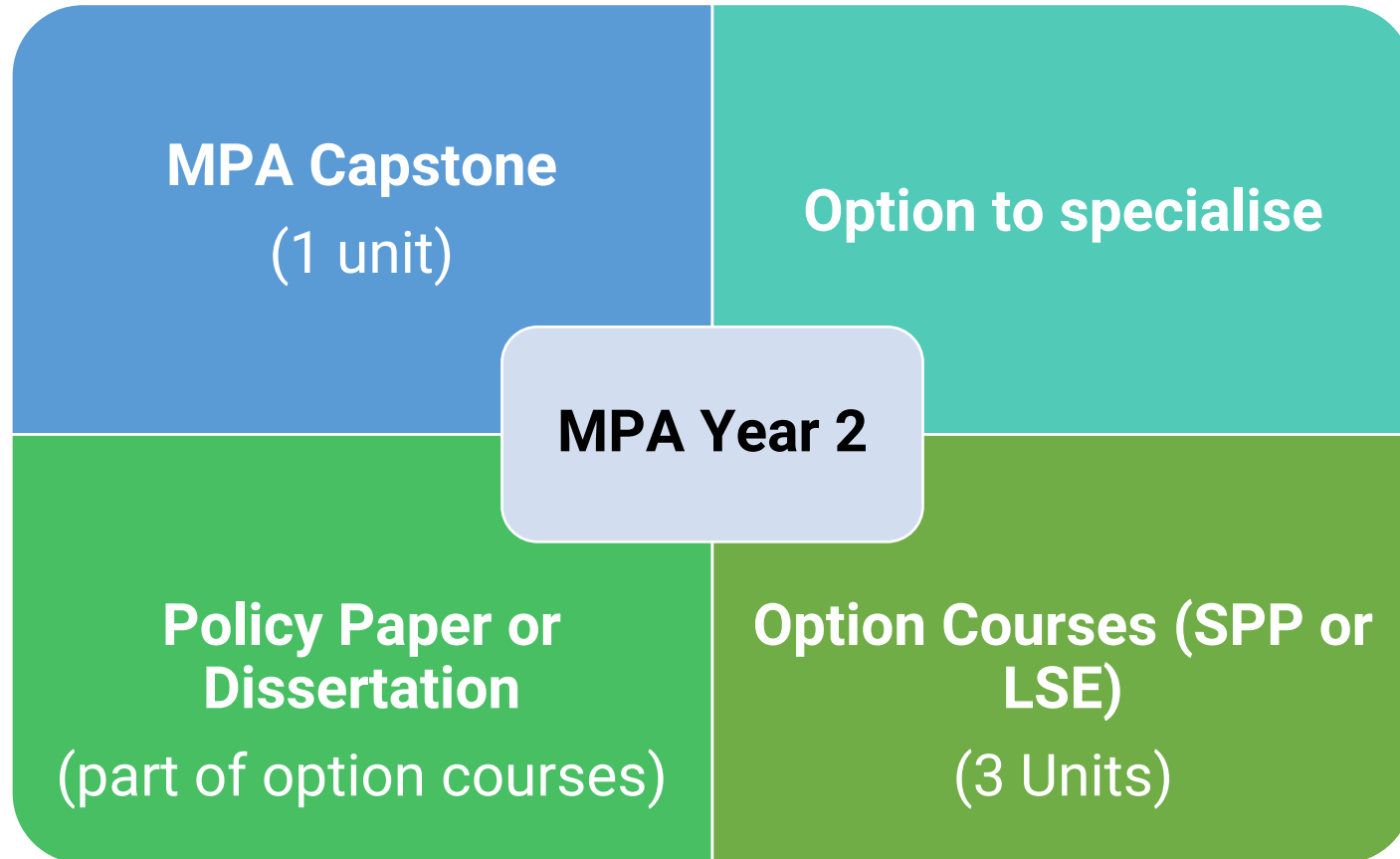

Second year MPA students can **specialise** in one of the following areas if they wish:

- Economic Policy
- International Development
- Inequality and Poverty
- Social Impact
- International Political Economy

The Capstone

Your opportunity to carry out original analysis & research addressing a pressing policy problem of great interest to one of our client organisations.

- An applied public policy project – Apply what you've learnt in a professional setting. Make a difference!
- You'll work as part of team (typically 4 – 5 students).
- Each team manages its own workload with the support of a Capstone supervisor (a member of the LSE faculty).
- These projects run from October to March alongside your other taught courses.
- Every spring our 2nd-year students tell us that delivering their team's (gorgeous) Capstone reports to their clients and presenting them with their findings were the biggest highlights of the year. It pulled everything together!



Capstone Clients

Some of our recent Capstone clients include:



SPP Student Networks and Opportunities

Global Public Policy Network (GPPN)

- Partnership between seven prestigious universities in public policy

SPP Student-led organisations

- Womxn's Network
- Association of Public Policy Students (APPS)
- Public Sphere Journal for Public Policy (PSJ)

Professional Development Programmes and Events

- SPP Professional Skills Accelerator
- Policy in Practice (PiP) seminars
- Turner MIINT programme
- Dean's Dialogues





SPP Careers and Alumni Support



Reserved one-to-one appointments with the SPP Careers Consultant for SPP students



Weekly SPP Careers Newsletter



SPP Career Networking Evening



Alumni panel events



An alumni network of 2000+

Next Steps – Prospective Students

Find out more about the MPA and Student Life at
www.lse.ac.uk/spp/study

Entry requirements:

- Upper second class honours (2:1) degree or equivalent in any discipline

Application deadlines:

- Apply as soon as possible.

Admissions support

- Admissions knowledge base and [Zoom sessions](#)
- For scholarship and financial support, please see [here](#).
- Got questions? Check out the [FAQ's webpage](#).



Next Steps – Offer Holders

- Congratulations on your offer!
- Check out the [offer holders webpage](#) for next steps and information.
- Join our [LinkedIn Offer Holder group](#).
- Got questions? Check out the [FAQ's webpage](#).